

**STATE OF NORTH CAROLINA
DEPARTMENT OF TRANSPORTATION**

**PAVEMENT MARKING PLAN
CHATHAM AND LEE COUNTIES**

LOCATION: VARIOUS

STATE	STATE PROJECT REFERENCE NO.	SHEET NO.	TOTAL SHEETS
N.C.	W-5708I	PMP-1	8
STATE PROJ. NO.	F.A. PROJ. NO.	DESCRIPTION	
W-5708I			
44854.3.9		CONST	

TIP: W-5708I

INDEX

SHEET NO.	DESCRIPTION
PMP-1	PAVEMENT MARKING PLAN TITLE AND SCHEDULE SHEET
PMP-2	PAVEMENT MARKING OVERVIEW MAP
PMP-3-6	PAVEMENT MARKING VACINITY MAP
TMP-1	TRAFFIC MANAGEMENT PLAN
SOQ-1	THERMOPLASTIC PM QUANTITIES

GENERAL NOTES

THE FOLLOWING GENERAL NOTES APPLY AT ALL TIMES FOR THE DURATION OF THE CONSTRUCTION PROJECT, EXCEPT WHEN OTHERWISE NOTED IN THE PLAN, OR DIRECTED BY THE ENGINEER.

A) INSTALL PAVEMENT MARKINGS AND PAVEMENT MARKERS AS FOLLOWS:

ROAD NAME	MARKING	MARKER
ALL	THERMOPLASTIC	*SEE NOTE BELOW

B) TIE PROPOSED PAVEMENT MARKING LINES TO EXISTING PAVEMENT MARKING LINES.

C) REMOVE/REPLACE ANY CONFLICTING/DAMAGED PAVEMENT MARKINGS AND MARKERS BY THE END OF EACH DAY'S OPERATION.

D) PRIOR TO PLACEMENT OF NEW PAVEMENT MARKINGS REMOVE EXISTING PAVEMENT MARKINGS BY ACCEPTABLE METHODS.

E) ALL PAVEMENT MARKING REMOVAL WILL BE AT THE DISCRETION OF THE ENGINEER.

* REPLACE MARKERS IF DAMAGED DURING PAVEMENT MARKING REMOVAL OR PAVEMENT MARKING INSTALLATION. THIS WORK SHALL BE INCIDENTAL TO PAVEMENT MARKING INSTALLATION.

ROADWAY STANDARD DRAWING

THE FOLLOWING ROADWAY STANDARDS AS APPEAR IN "ROADWAY STANDARD DRAWINGS" - PROJECT SERVICES UNIT - N.C. DEPARTMENT OF TRANSPORTATION - RALEIGH, N.C., DATED JANUARY 2018 ARE APPLICABLE TO THIS PROJECT AND BY REFERENCE HEREBY ARE CONSIDERED A PART OF THESE PLANS:

STD. NO.	TITLE
1101.02	TEMPORARY LANE CLOSURES
1101.04	TEMPORARY SHOULDER CLOSURES
1101.11	TRAFFIC CONTROL DESIGN TABLES
1110.02	PORTABLE WORK ZONE SIGNS
1115.01	FLASHING ARROW BOARDS
1130.01	DRUM
1135.01	CONES
1150.01	FLAGGING DEVICES
1165.01	WORK VEHICLE LIGHTING SYSTEMS AND TMA DELINEATION
1180.01	SKINNY-DRUM
1205.01	PAVEMENT MARKINGS - LINE TYPES AND OFFSETS
1205.02	PAVEMENT MARKINGS - TWO-LANE AND MULTILANE ROADWAYS
1205.12	PAVEMENT MARKINGS - BRIDGES

PAVEMENT MARKING SCHEDULE

REMOVAL OF PAVEMENT MARKINGS LINES (4")

REMOVAL OF PAVEMENT MARKING LINES (8")

REMOVAL OF PAVEMENT MARKING LINES (24")

REMOVAL OF PAVEMENT MARKING SYMBOLS & CHARACTERS

THERMO(4", 120 MILS) YELLOW

THERMO(4", 90 MILS) WHITE

THERMO(4", 120 MILS) WHITE

THERMO(12", 90 MILS) YELLOW

THERMO (24", 120 MILS) WHITE

THERMO PAVEMENT MARKING CHARACTER (120 MILS)

THERMO PAVEMENT MARKING SYMBOL (90 MILS)

DIVISION DESIGN ENGINEER



DocuSigned by:
Greg S. Davis
3304785FD78F4A8 9/20/2018

20-SEP-2018 11:05 AM C:\Users\jdh\d\OneDrive\Documents\Projects\5708I\TIP.dgn

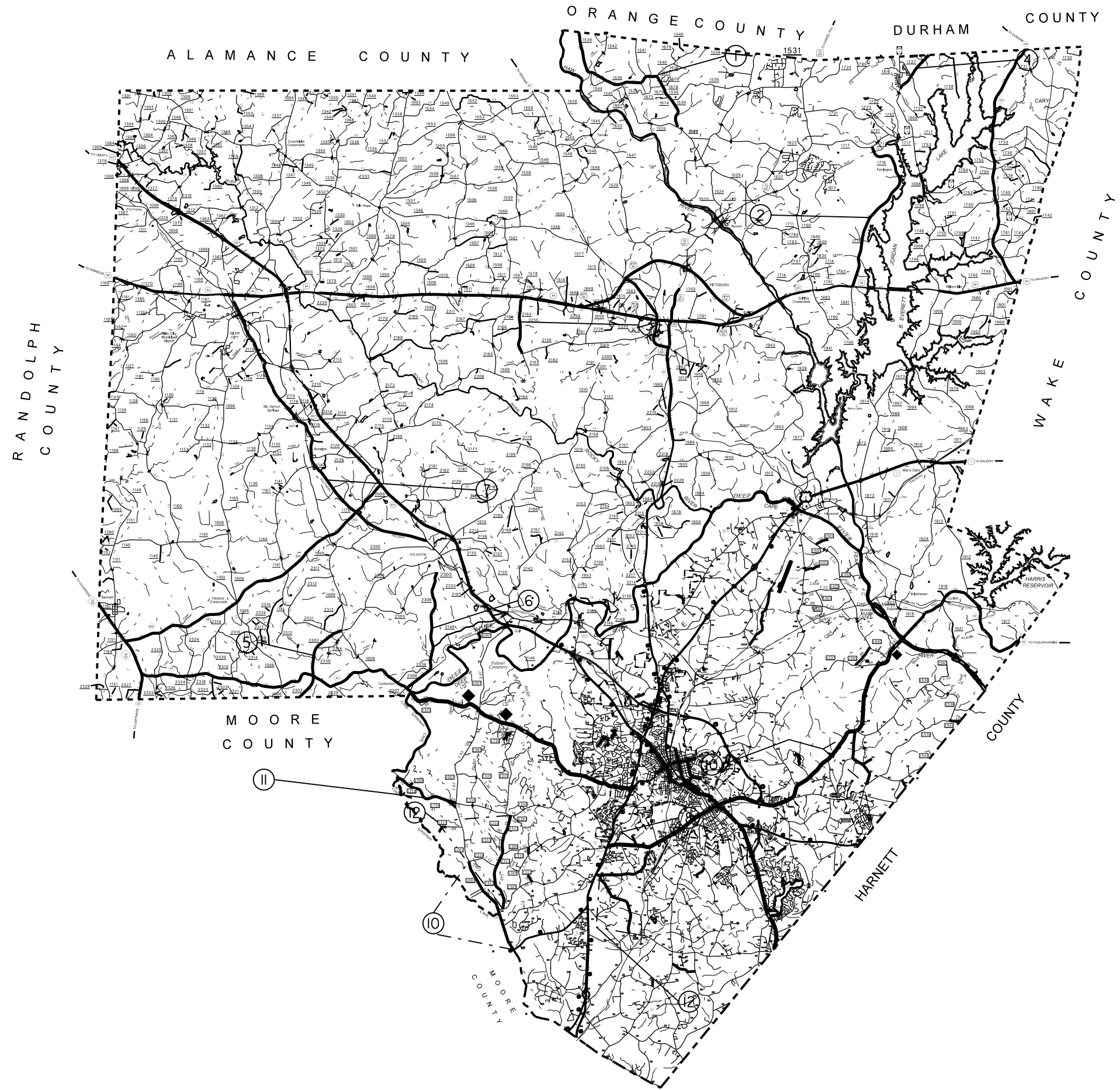

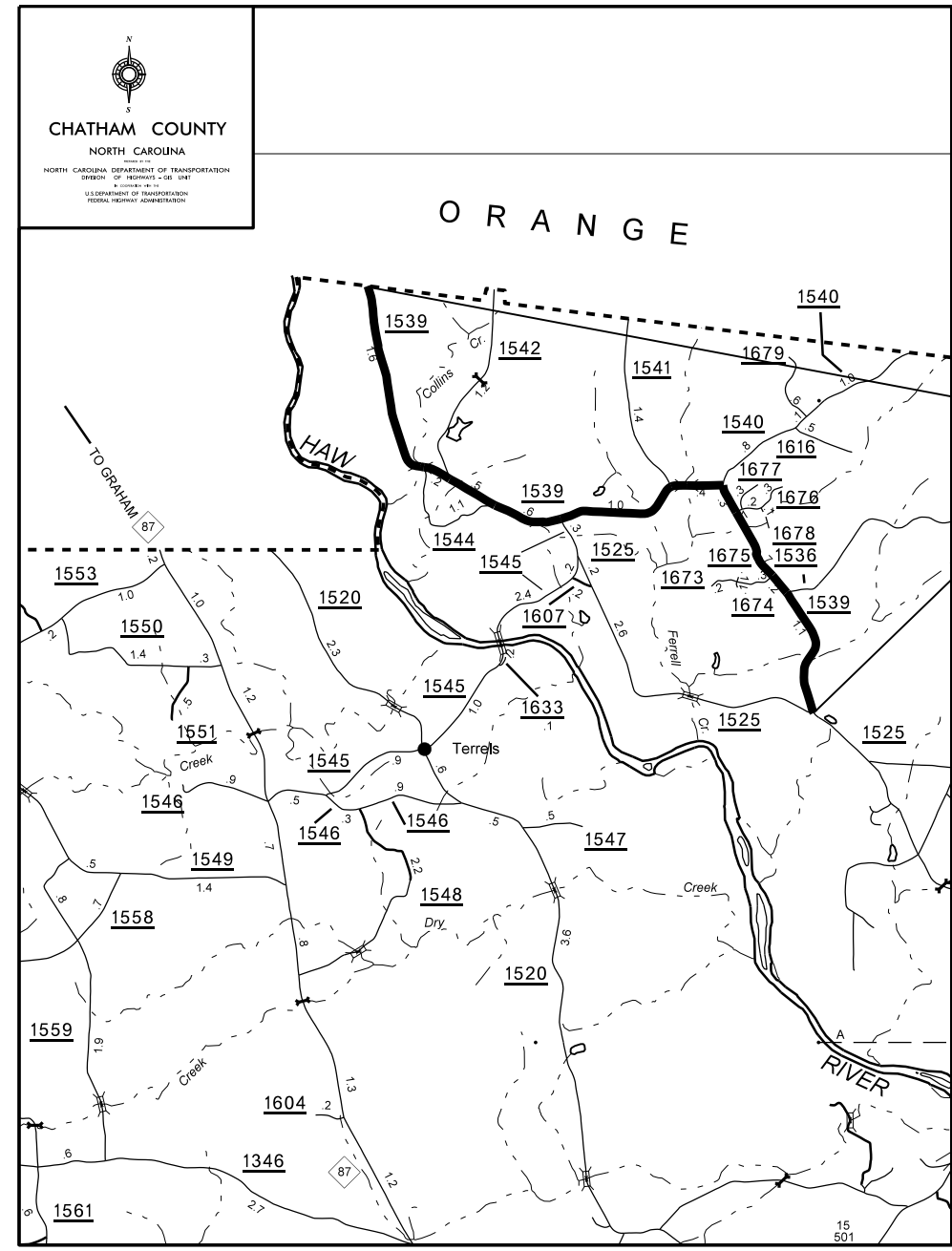

2

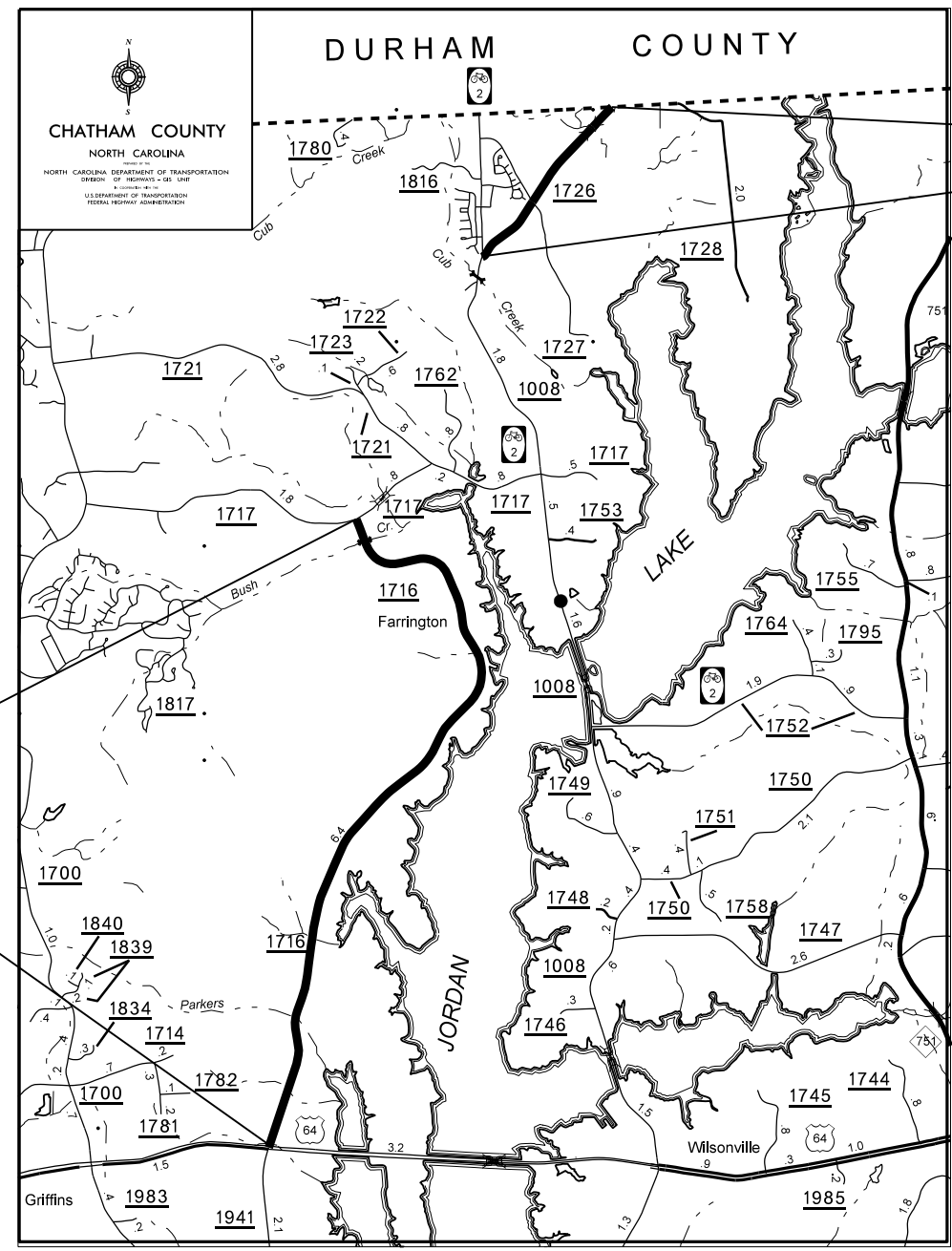

4

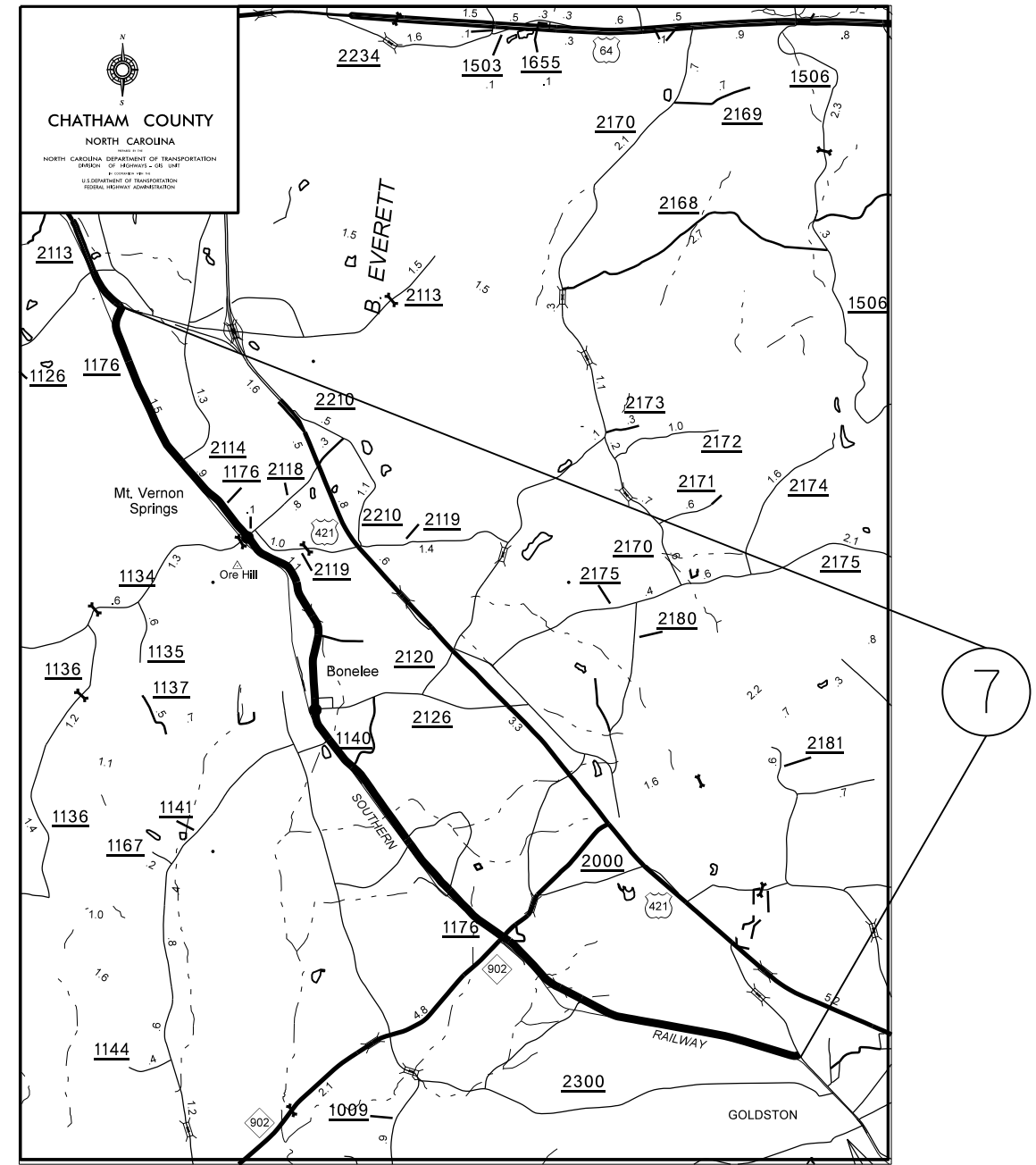
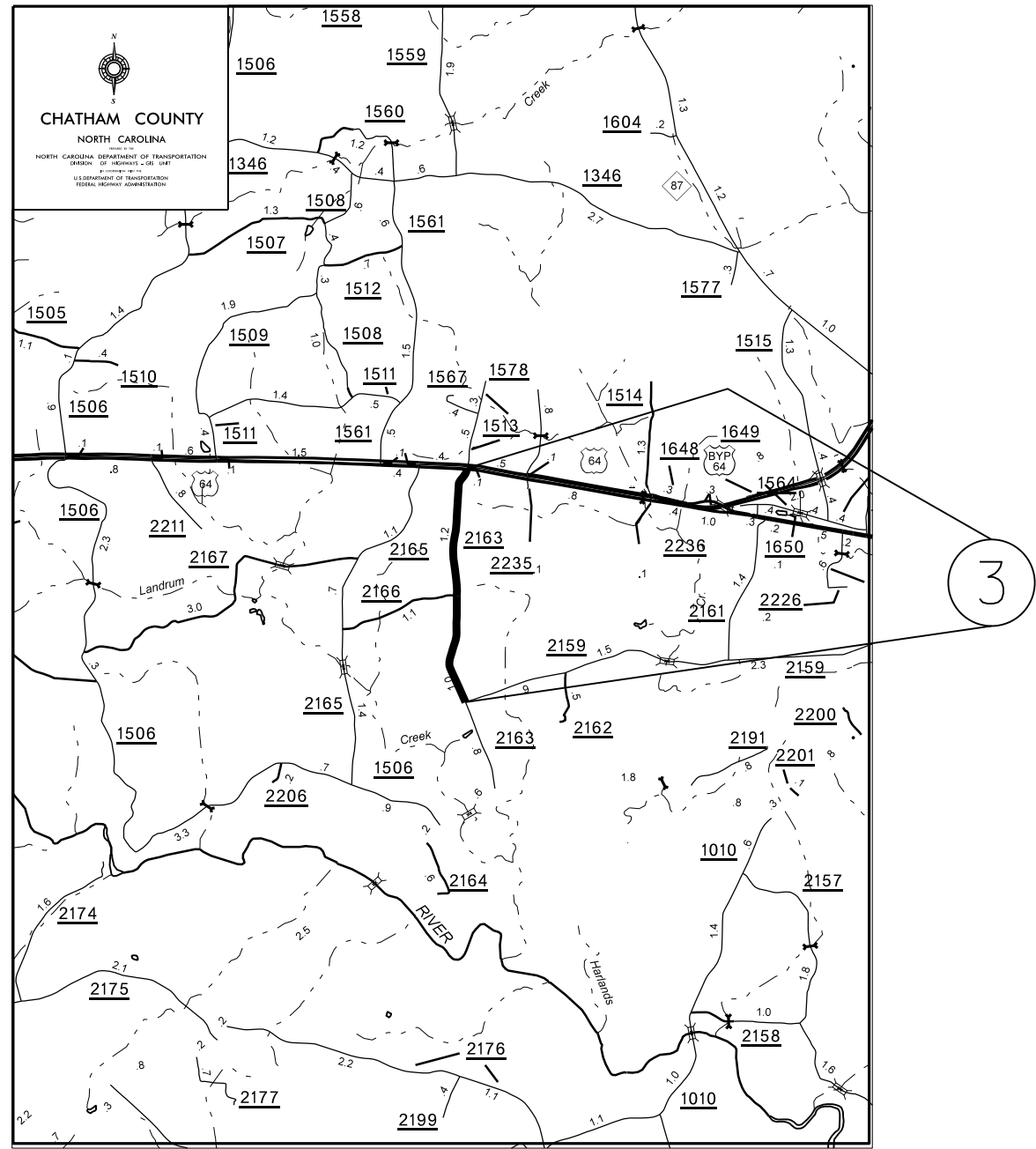

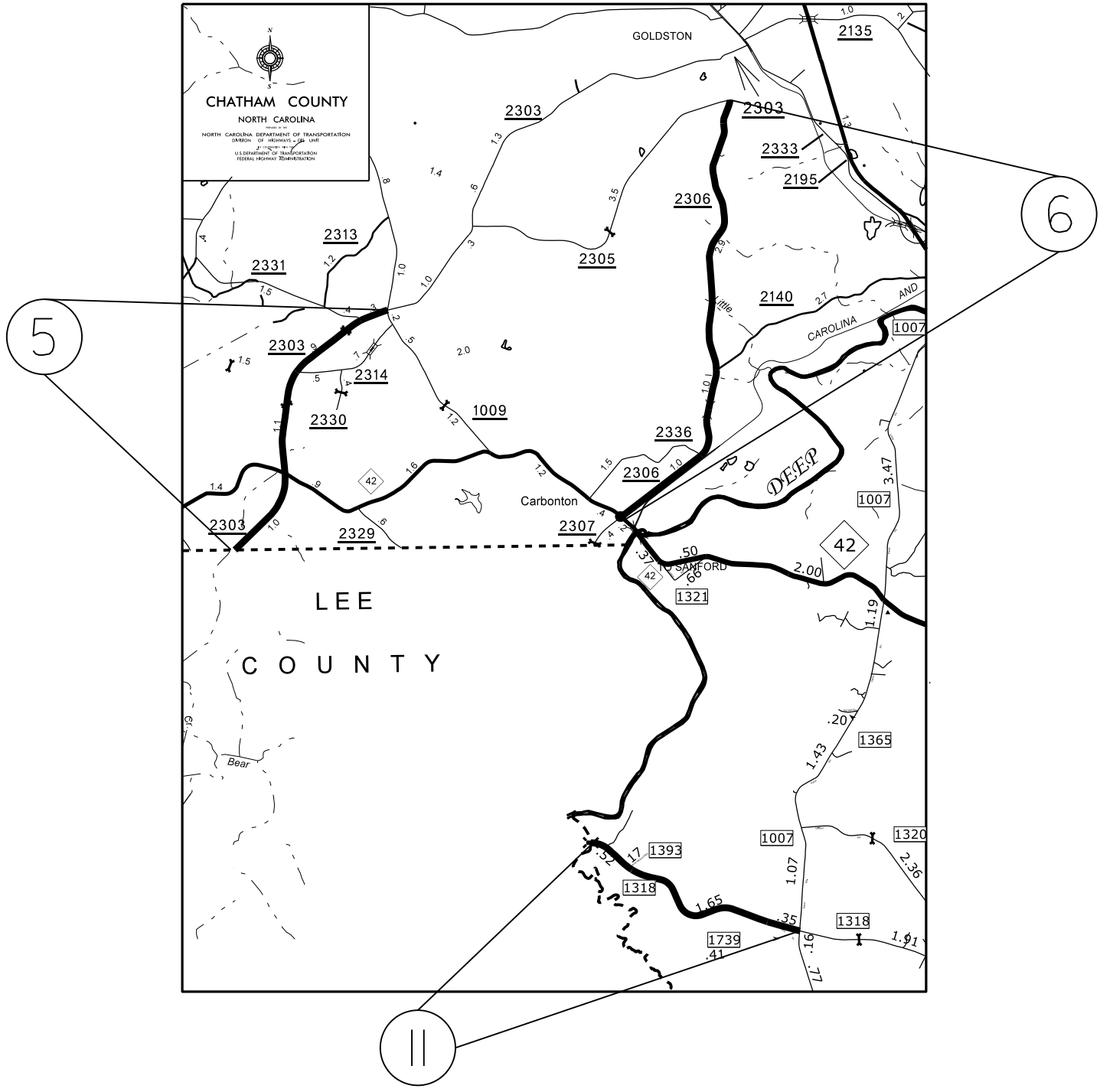

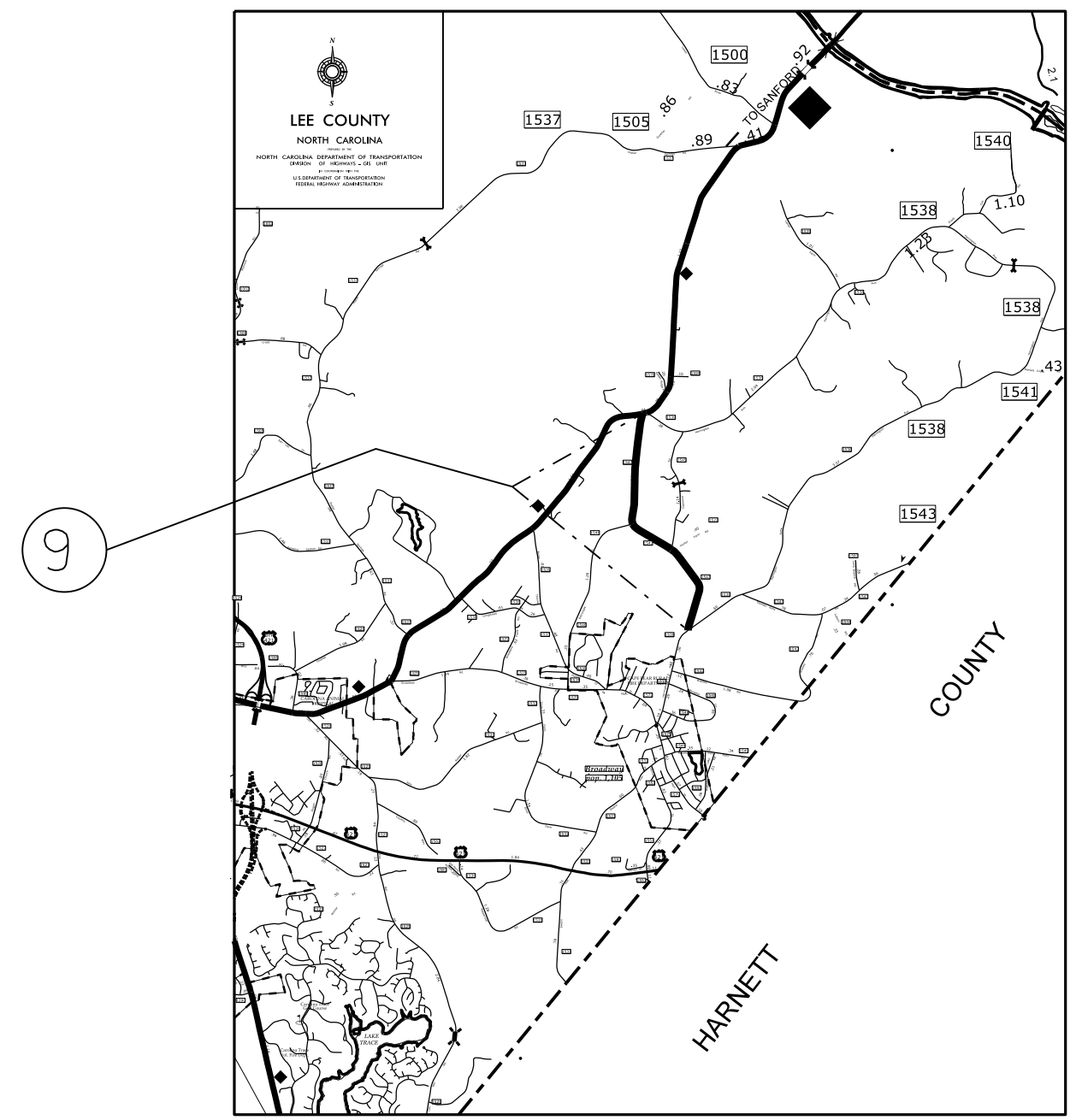
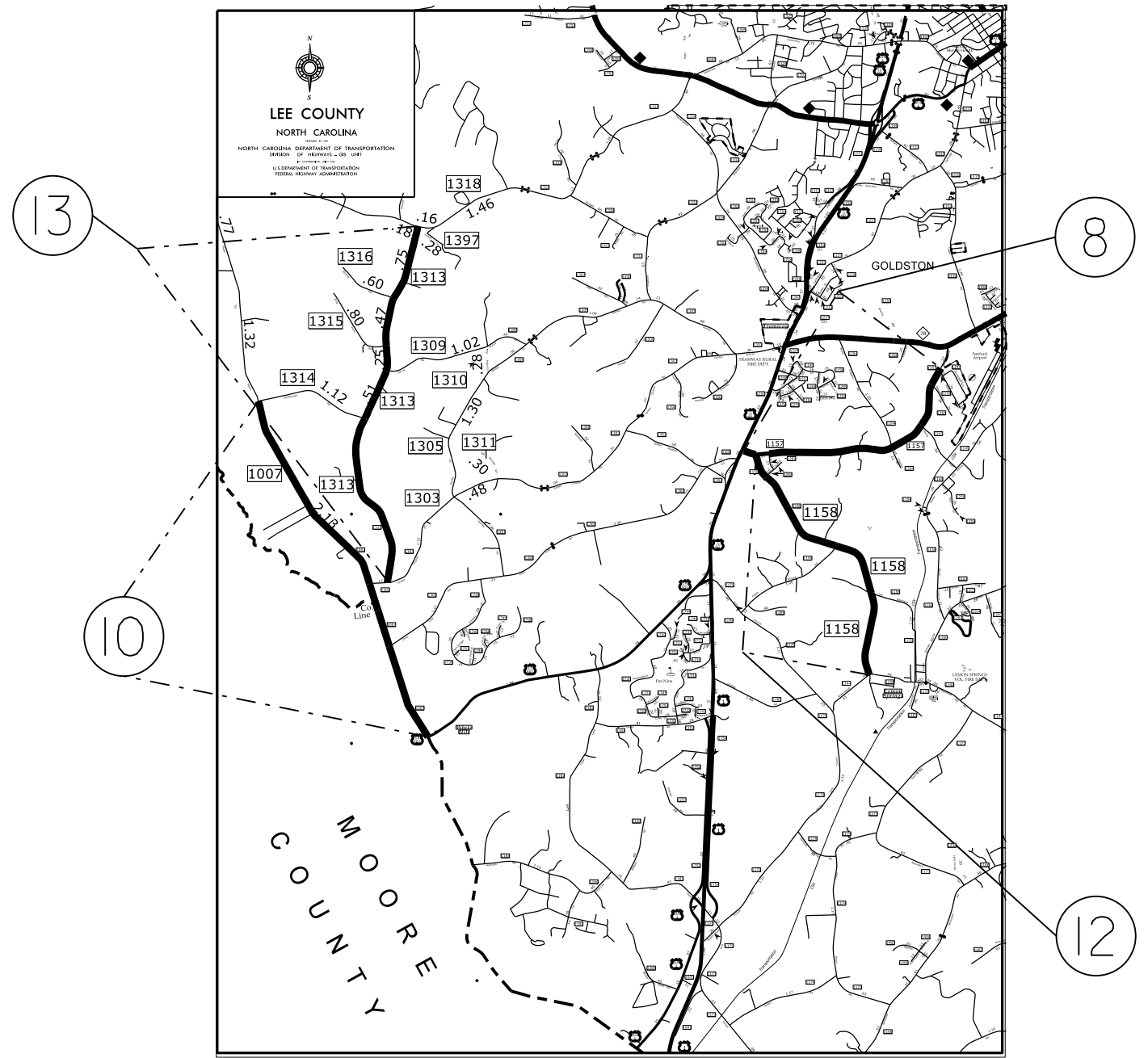

GENERAL NOTES

CHANGES MAY BE REQUIRED WHEN PHYSICAL DIMENSIONS IN THE DETAIL DRAWINGS, STANDARD DETAILS AND ROADWAY DETAILS ARE NOT ATTAINABLE TO MEET FIELD CONDITIONS, OR RESULT IN DUPLICATE, OR UNDESIRE OVERLAPPING OF DEVICES. MODIFICATION MAY INCLUDE: MOVING, SUPPLEMENTING, COVERING OR REMOVAL OF DEVICES, AS DIRECTED BY THE ENGINEER.

THE FOLLOWING GENERAL NOTES APPLY AT ALL TIMES FOR THE DURATION OF THE CONSTRUCTION PROJECT, EXCEPT WHEN OTHERWISE NOTED IN THE PLAN, OR DIRECTED BY THE ENGINEER.

TIME RESTRICTIONS

- A) DO NOT CLOSE OR NARROW TRAVEL LANES AS FOLLOWS:

ROAD NAME	DAY AND TIME RESTRICTION
ALL ROADS	MONDAY THRU FRIDAY 7:00 AM - 9:00 AM

- B) DO NOT CLOSE OR NARROW TRAVEL LANES DURING HOLIDAYS AND SPECIAL EVENTS AS FOLLOWS:

ROAD NAME
ALL ROADS

HOLIDAY

1. FOR ANY UNEXPECTED OCCURRENCE THAT CREATES UNUSUALLY HIGH TRAFFIC VOLUMES, AS DIRECTED BY THE ENGINEER.
2. FOR NEW YEAR'S, BETWEEN THE HOURS OF 7:00 A.M. DECEMBER 31st TO 6:00 P.M. JANUARY 2ND. IF NEW YEAR'S DAY IS ON A FRIDAY, SATURDAY, SUNDAY, OR MONDAY THEN UNTIL 6:00 P.M. THE FOLLOWING TUESDAY.
3. FOR EASTER, BETWEEN THE HOURS OF 7:00 A.M. THURSDAY AND 6:00 P.M. MONDAY.
4. FOR MEMORIAL DAY, BETWEEN THE HOURS OF 7:00 A.M. FRIDAY TO 6:00 P.M. TUESDAY.
5. FOR INDEPENDENCE DAY, BETWEEN THE HOURS OF 7:00 A.M. THE DAY BEFORE INDEPENDENCE DAY AND 6:00 P.M. THE DAY AFTER INDEPENDENCE DAY.

IF INDEPENDENCE DAY IS ON A FRIDAY, SATURDAY, SUNDAY OR MONDAY THEN BETWEEN THE HOURS OF 7:00 A.M. THE THURSDAY BEFORE INDEPENDENCE DAY AND 6:00 P.M. THE TUESDAY AFTER INDEPENDENCE DAY.
6. FOR LABOR DAY, BETWEEN THE HOURS OF 7:00 A.M. FRIDAY AND 6:00 P.M. TUESDAY.
7. FOR THANKSGIVING DAY, BETWEEN THE HOURS OF 7:00 A.M. TUESDAY TO 6:00 P.M. MONDAY.
8. FOR CHRISTMAS, BETWEEN THE HOURS OF 7:00 A.M. THE FRIDAY BEFORE THE WEEK OF CHRISTMAS DAY AND 6:00 P.M. THE FOLLOWING TUESDAY AFTER THE WEEK OF CHRISTMAS.

MANAGEMENT STRATEGIES

- UTILIZING LANE CLOSURES, AND PLACE THERMO MARKINGS AS OUTLINED IN EACH MAP.

PHASING

STEP 1:
INSTALL WORK ZONE ADVANCE WARNING SIGNS IN ACCORDANCE WITH NCDOT ROADWAY STANDARD DRAWING NO. 1101.01. WHEN NO WORK IS BEING CONDUCTED FOR A PERIOD LONGER THAN ONE WEEK, REMOVE OR COVER ALL ADVANCE WORK ZONE SIGNS, AS DIRECTED BY THE ENGINEER.

STEP 2:

USING NCDOT STANDARD DRAWING NO. 1101.02 (SHEET 1 OF 15), ON MAPS #1 THRU #13, BEGIN THERMO PAVEMENT MARKINGS AS OUTLINED FOR EACH MAP.

STEP 3:

REMOVE ALL WORK ZONE TRAFFIC CONTROL DEVICES AND OPEN ALL MAPS TO FINAL TRAFFIC PATTERN AT THE COMPLETION OF EACH MAP.

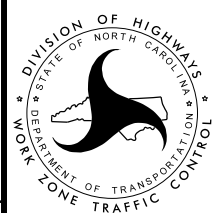
APPROVED: <u>Greg S. Davis</u> <small>DocuSigned by: Greg S. Davis 3324789172781404</small>	DATE: <u>9/20/2018</u> SEAL			<h1 style="margin: 0;">TRAFFIC MANAGEMENT PLAN</h1>
DOCUMENT NOT CONSIDERED FINAL UNLESS ALL SIGNATURES COMPLETED				

